

尺寸及量程 / Size and Capacity

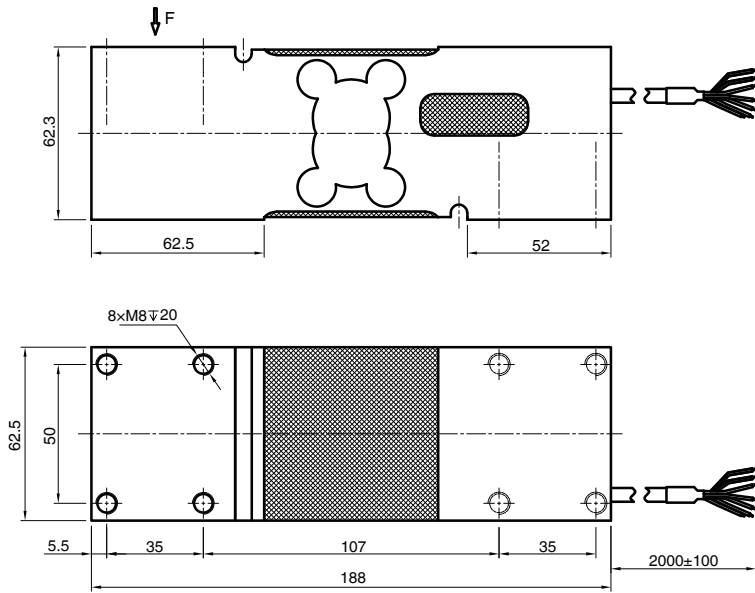

| 量程 / Capacity (kg) | 材料 / Material | 重量 / Weight |
|---------------------------------------|----------------------|-------------|
| 50/75/100/150/200/ 250/300/500/635 | 铝合金 / Aluminum alloy | 2 kg |

技术参数 / Technical Parameters

| 参数 | Specifications | 技术指标 / Technique |
|-----------|-------------------------|---|
| 输出灵敏度 | Rated output | 2.0 ± 0.2 mV/V |
| 零点输出 | Zero balance | ± 5% F.S. |
| 非线性 | Non-linearity | ±0.02%F.S. |
| 滞后 | Hysteresis | ±0.02%F.S. |
| 重复性 | Repeatability | ±0.02%F.S. |
| 蠕变 (30分钟) | Creep (30min) | ±0.02%F.S. |
| 灵敏度温度漂移 | Temp. effect on output | ±0.02% F.S. / 10°C |
| 零点温度漂移 | Temp. effect on zero | ±0.014%F.S. / 10°C |
| 输入电阻 | Input impedance | 410 ± 20 Ω |
| 输出电阻 | Output impedance | 350 ± 3 Ω |
| 绝缘电阻 | Insulation | ≥5000MΩ/100VDC |
| 使用电压 | Recommended excitation | 5...10 VDC |
| 最大使用电压 | Maximum excitation | 15 VDC |
| 温度补偿范围 | Compensated temp. range | -10...+40°C |
| 工作温度范围 | Operation temp. range | -20...+65°C |
| 安全超载 | Safe overload | 150% F.S. |
| 极限超载 | Ultimate overload | 200% F.S. |
| 电缆线尺寸 | Cable size | Ø5×2,000 mm |
| 台面尺寸 | Platform size | 600×600 mm |
| 防护等级 | Protection class | IP67 |
| 连接方式 | Cable color code | Input: Red (Exc+) Black (Exc-) Sense: Blue (Sen+) Yellow (Sen-) Output: Green (Sig+) White (Sig-) Shield: Yellow-Green 输入: 红 (Exc+) 黑 (Exc-) 反馈: 蓝 (Sen+) 黄 (Sen-) 输出: 绿 (Sig+) 白 (Sig-) 屏蔽线: 黄绿 |



特点和用途 / Features & Applications

- 优秀的动态响应性，称重效率高
- 综合精度高，对温度变化不敏感
- 偏心负载补偿
- 极具性价比的称重解决方案
- 适用于大量程和大尺寸的检重秤、皮带秤称重应用
- Excellent dynamic responsiveness, to raise weighing efficiency
- High accuracy with low temperature drift
- Off-center load compensation
- Extremely cost effective weighing solution
- Suitable for high rating and big sizes of checkweigher and belt weighing applications

受力方式 / Load Direction

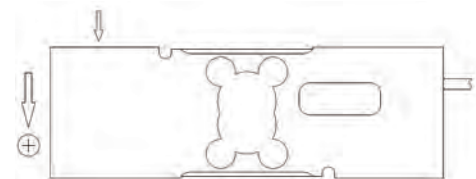

接线图 / Schematic Wiring Diagram

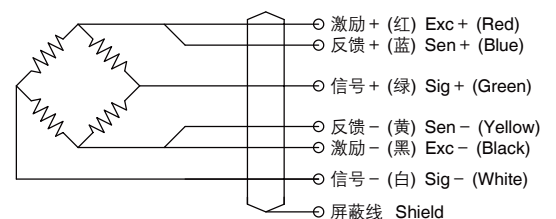

注：屏蔽线接弹性体。
Shield is connected to spring body.